

Zenith



# ZL120115

## Constant Current Discharge Rating Amperes @ 25°C (77°F)

Cut off voltage V/cell	30M	45M	1H	2H	3H	5H	8H	10H	12H	20H	24H
1.75V	16	12	9.4	5.2	3.8	2.7	1.8	1.53	1.3	0.85	0.71

## Specifications

Nominal Voltage		12V
Rated Capacity (20 hour rate)		18Ah
Dimension	Total Height (with terminals)	167mm (6.57 inches)
	Height	167mm (6.57 inches)
	Length	181mm (7.13 inches)
	Width	77mm (3.03 inches)
Weight		Approx. 6.22kg (13.71 lbs)

## Characteristics

Capacity 25°C (77°F)	20 hour rate (0.85A to 10.5Volts) 10 hour rate (1.53A to 10.5Volts) 5 hour rate (2.78A to 10.2Volts)	18AH 15.3AH 13.9AH
Internal Resistance	Full charged Battery 25°C (77°F)	12mΩ
Capacity affected by Temperature (20 hour rate)	40°C (104°F) 25°C (77°F) 0°C (32°F) -15°C (5°F)	102% 100% 85% 65%
Self-Discharge 25°C (77°F)	Capacity after 3 month storage Capacity after 6 month storage Capacity after 12 month storage	91% 82% 64%
Standard Terminal	M5	
Max. Discharge Current 25°C (77°F)	300A (5s)	
Cranking Performance	Cranking Amps (30-sec amps to 7.2V @ 0°C (32°F)) Cold Cranking Amps (30-sec amps to 7.2V @ -18°C (0°F))	148A 120A
Reserve Capacity (Minutes to 10.5V at 27°C (80°F))	@ 25Amps @ 75Amps	20Min
Charging (Constant Voltage)	Cycle Initial Charging Current 3.4A Or Small 14.5V~14.9V/ 25°C (77°F) Float 13.6V~13.8V/ 25°C (77°F)	

## Discharge characteristics 25°C (77°F)

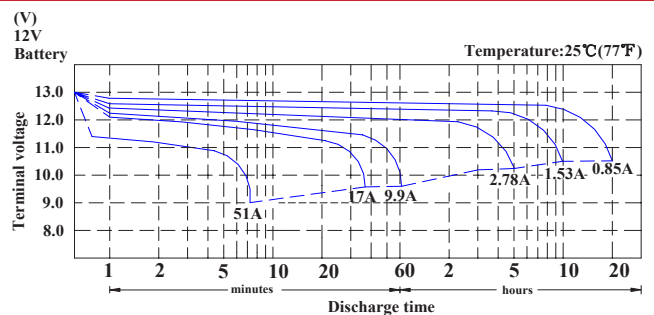

## Duration of discharge vs. Discharge current

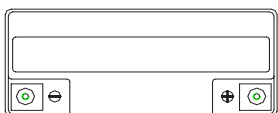
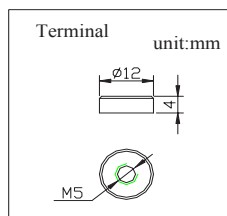
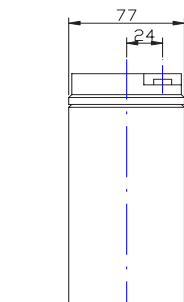
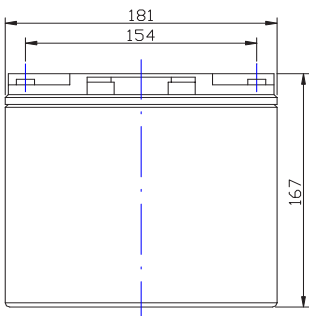
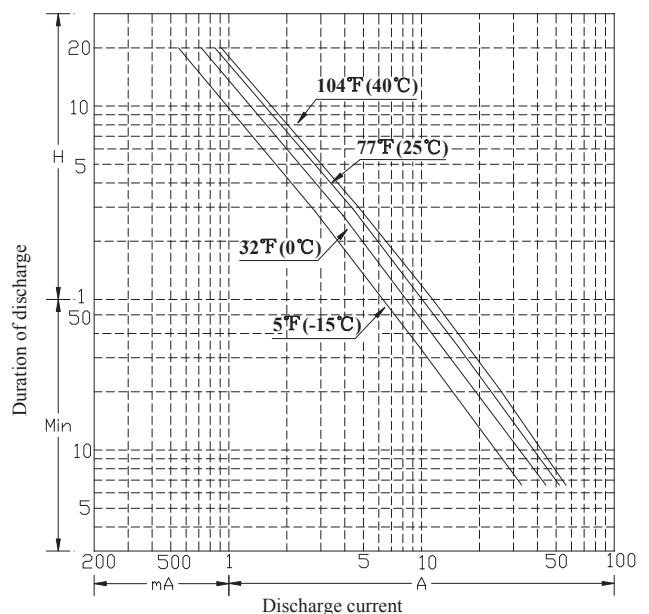

This information is generally descriptive only and is not intended to make or imply any representation, guarantee or warranty with respect to any cells and batteries. Cell and battery designs/specification are subject to modification without notice. Contact U.B.S. UNION BATTERY SERVICE for the latest information.

DIVISION OF



[www.zenithdcbattery.com](http://www.zenithdcbattery.com)